

Nozzles for Blowing

Series KN

Air Blow

Air Tool

Coolant

Nozzle with self-align fitting/KN

(mm)



Model	Nozzle size D	Connection size	Width across flats		L1	L2
			H1	H2		
KN-04-100	ø1	ø4	10	10	27	15
KN-04-150	ø1.5	ø4	10	10	27.7	15
KN-06-100	ø1	ø6	12	12	30.1	16
KN-06-150	ø1.5	ø6	12	12	30.8	16
KN-06-200	ø2	ø6	12	12	31.5	16
KN-08-150	ø1.5	ø8	14	14	33.8	16
KN-08-200	ø2	ø8	14	14	34.6	16
KN-10-250	ø2.5	ø10	14	17	35.6	17
KN-10-300	ø3	ø10	14	17	36.3	17
KN-10-350	ø3.5	ø10	14	17	37.1	17
KN-10-400	ø4	ø10	14	17	29.5	17
KN-10-600	ø6	ø10	14	17	27.7	17
KN-12-350	ø3.5	ø12	17	19	40.4	17
KN-12-400	ø4	ø12	17	19	41.3	17
KN-12-600	ø6	ø12	17	19	31.2	17
KN-16-400	ø4	ø16	22	24	40.1	17
KN-16-600	ø6	ø16	22	24	38.4	17
KN-20-400	ø4	ø20	26	27	45.6	17
KN-20-600	ø6	ø20	26	27	43.9	17

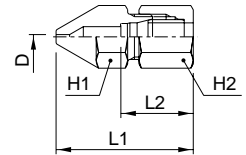

Nozzle with male thread/KN

(mm)



Model	Nozzle size D	Connection size	Width across flats	L1	A
			H1		
KN-R01-100	ø1	R 1/8	10	21.4	17.4
KN-R01-150	ø1.5	R 1/8	10	21	17
KN-R02-100	ø1	R 1/4	14	31.4	25.4
KN-R02-150	ø1.5	R 1/4	14	31	25
KN-R02-200	ø2	R 1/4	14	30.5	24.5
KN-R02-250	ø2.5	R 1/4	14	30.1	24.1
KN-R02-600	ø6	R 1/4	14	27.1	21.1
KN-R03-400	ø4	R 3/8	17	31.8	25.4
KN-R03-600	ø6	R 3/8	17	30.1	23.7
KN-R04-400	ø4	R 1/2	22	41.8	33.6
KN-R04-600	ø6	R 1/2	22	40.1	31.8
KN-R06-600	ø6	R 3/4	27	49.6	40.1
KN-R06-800	ø8	R 3/4	27	47.8	38
KN-R10-800	ø8	R 1	36	62.8	52.4

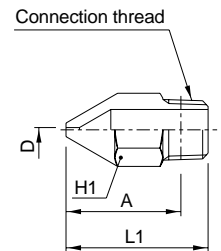

Copper extension nozzle/KNL

(mm)



Model	Nozzle size D	Outside diameter	L1
KNL3-06-150	ø1.5	ø6	300
KNL3-06-200	ø2	ø6	300
KNL3-08-200	ø2	ø8	300
KNL3-08-250	ø2.5	ø8	300
KNL3-10-250	ø2.5	ø10	300
KNL3-10-300	ø3	ø10	300
KNL6-06-150	ø1.5	ø6	600
KNL6-06-200	ø2	ø6	600
KNL6-08-200	ø2	ø8	600
KNL6-08-250	ø2.5	ø8	600
KNL6-10-250	ø2.5	ø10	600
KNL6-10-300	ø3	ø10	600

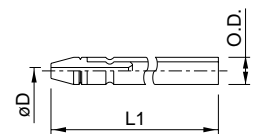

Nozzle for One-touch fitting/KN

(mm)



Model	Nozzle size D	Connection size	L ₁	A
KN-Q06-100	ø1	ø6	35	18
KN-Q06-150	ø1.5	ø6	35	18
KN-Q06-200	ø2	ø6	35	18
KN-Q08-150	ø1.5	ø8	39	20.5
KN-Q08-200	ø2	ø8	39	20.5
KN-Q10-200	ø2	ø10	43	22
KN-Q10-250	ø2.5	ø10	43	22
KN-Q12-250	ø2.5	ø12	45.5	24
KN-Q12-300	ø3	ø12	45.5	24

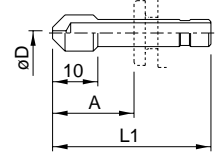

Pivoting nozzle with self-align fitting/KNK

(mm)



Model	Nozzle size D	Connection size	Width across flats		L ₁	L ₂
			H ₁	H ₂		
KNK-10-400	ø4	ø10	17	17	41.7	17
KNK-10-600	ø6	ø10	17	17	41.7	17
KNK-12-400	ø4	ø12	17	19	41.2	17
KNK-12-600	ø6	ø12	17	19	41.2	17
KNK-16-400	ø4	ø16	17	24	41.8	17
KNK-16-600	ø6	ø16	17	24	41.8	17
KNK-20-400	ø4	ø20	17	27	43.8	17
KNK-20-600	ø6	ø20	17	27	43.8	17

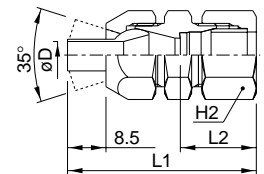

Pivoting nozzle with male thread/KNK

(mm)



Model	Nozzle size D	Connection size	Width across flats		L ₁	A
			H ₁	H ₂		
KNK-R02-400	ø4	R 1/4	17	17	38	31.9
KNK-R02-600	ø6	R 1/4	17	17	38	31.9
KNK-R03-400	ø4	R 3/8	17	17	39	32.4
KNK-R03-600	ø6	R 3/8	17	17	39	32.4
KNK-R04-400	ø4	R 1/2	17	22	42.2	34.1
KNK-R04-600	ø6	R 1/2	17	22	42.2	34.1

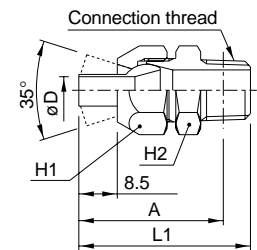

Auxiliary Pneumatic Equipment
Air Preparation Equipment

High efficiency nozzle/KNH

(mm)



Model	Nozzle size D	Connection size	Width across flats	L ₁	A
			H ₁		
KNH-R02-100	ø1	R 1/4	14	52	46
KNH-R02-150	ø1.5	R 1/4	14	52	46
KNH-R02-200	ø2	R 1/4	14	52	46

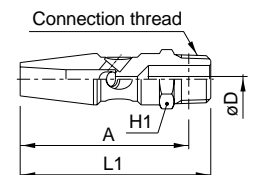

Low noise nozzle with self-align fitting/KNS

(mm)



Model	Nozzle size D	Connection size	Width across flats		L ₁	L ₂
			H ₁	H ₂		
KNS-08-075-4	ø0.75 x 4	ø8	12	14	24.3	16
KNS-08-100-4	ø1 x 4	ø8	12	14	24.3	16
KNS-10-075-4	ø0.75 x 4	ø10	14	17	24	17
KNS-10-090-8	ø0.9 x 8	ø10	14	17	24	17
KNS-10-100-4	ø1 x 4	ø10	14	17	24	17

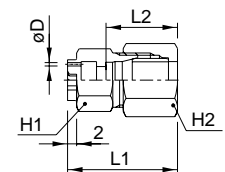

Low noise nozzle with male thread/KNS

(mm)



Model	Nozzle size D	Connection size	Width across flats	L ₁	A
			H ₁		
KNS-R01-075-4	ø0.75 x 4	R 1/8	12	18	14
KNS-R01-100-4	ø1 x 4	R 1/8	12	18	14
KNS-R01-090-8	ø0.9 x 8	R 1/8	12	18	14
KNS-R02-075-4	ø0.75 x 4	R 1/4	14	20	14
KNS-R02-090-8	ø0.9 x 8	R 1/4	14	20	14
KNS-R02-100-4	ø1 x 4	R 1/4	14	20	14
KNS-R02-110-8	ø1.1 x 8	R 1/4	14	20	14

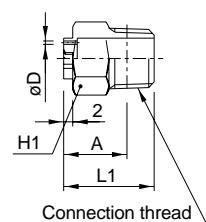

Series KN

Sensing Heads

Standard sensing head



Model	Nozzle size D	Connection size	Width across flats		L1	L2
			H1	H2		
KNP-1	ø2.5	ø4	5	8	63.7	1000

* A 1m polyurethane tube is included.

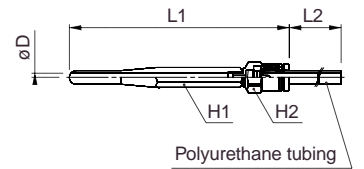

Needle sensing head



Model	Nozzle size D	Connection size	Cassette size	A	L1	L2	L3
			H1				
KNP-2	ø0.7	ø4	5	12.7	41	1000	23

* A 1m polyurethane tube is included.

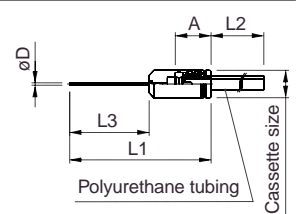

Use to measure work piece collision pressure.

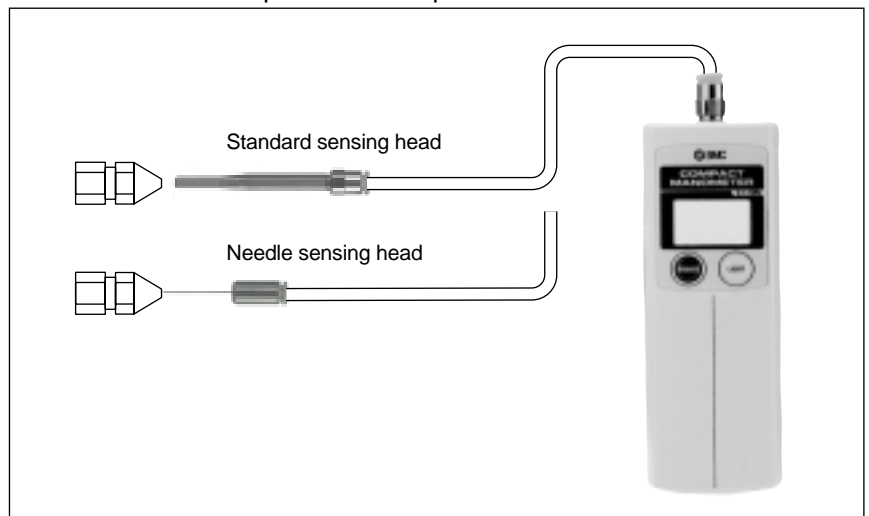

Specifications

Nozzle (KN, KNK, KNH, KNS, KNL)

Applicable tubing material		Nylon, Soft nylon, Flexible copper pipe (C1220T-O), OST pipe
Applicable piping O.D. mm		ø4, ø6, ø8, ø10, ø12, ø16, ø20
Fluid		Air, Coolant
Maximum operating pressure		1.0MPa (0.3MPa with SGP pipe)
Ambient and fluid temperature		-5 to 60°C (with no freezing)
Threads	Mounting	JISB0203 (taper threads for piping)
	Nut	JISB0211, class 2 (taper threads for piping)
Seal for R threads		None

Sensing head (KNP)

Applicable fitting size	ø4
Fluid	Air
Maximum operating pressure (at 20°C)	0.8MPa
Ambient and fluid temperature	-5 to 60°C (with no freezing)